

linear dimension(Tolerances Standard GB/T 14486-2008)								—	∇	\perp
variable range	to	over 6	over 10	over 30	over 60	over 100	over 160	to	over 10	over 100
	6	to 10	to 30	to 60	to 100	to 160	to 10		to 100	to
tolerance	± 0.20	± 0.30	± 0.50	± 0.70	± 1.00	± 1.30	± 1.60	0.10	0.30	0.60

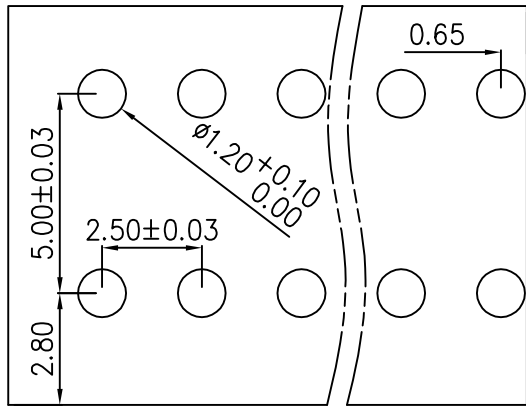

PCB Layout

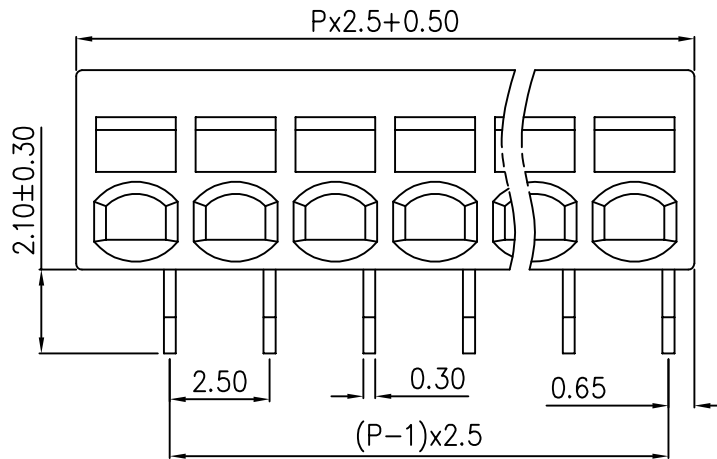
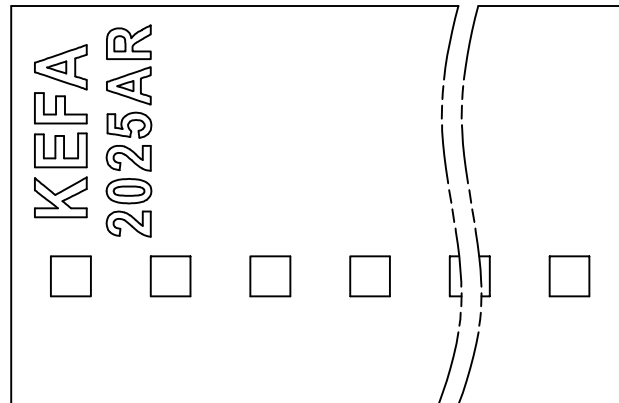
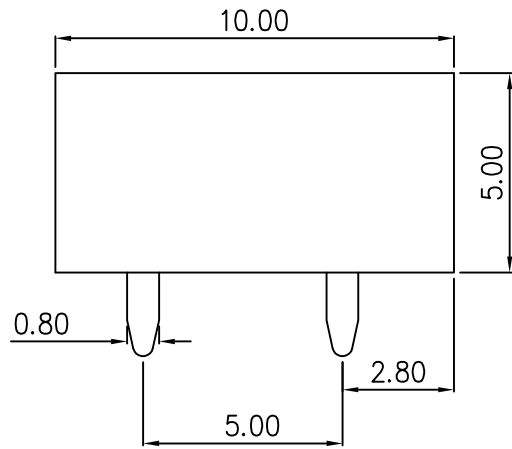

REVISION RECORD				
REV.	DESCRIPTION	ECN No.	APPROVED	DATE
A	新发行		CLF	21.11.15

UL/CUL 技术参数 UL/CUL Technical Data								
等级	Use Group		B	C	D			
额定电压	Rated Voltage [V]		150	-	-			
额定电流	Rated Current [A]		5	-	-			
接线范围	Wire Range		24-20					
单/多芯线	Solid/Stranded [AWG]							
耐电压	Withstanding Voltage		1300V/1Min					
IEC 技术参数 IEC Technical Data								
过电压类别	Overvoltage Category		III	III	II			
污染等级	Contamination Class		3	2	2			
额定电压	Rated Voltage [V]		100	160	320			
额定电流	Rated Current [A]		6	6	6			
额定冲击电压	Impulse withstand voltage ^a [KV]		2.5	2.5	2.5			
导线截面积	Conductor cross section		0.5					
硬质/柔性导线	Solid/flexible [mm ²]							
材料 Material								
绝缘材料	Insulation Material		PA46					
阻燃等级	Imflamability		UL94V-0					
导体材料	Contactive Material		铜合金 Copper alloy					
导体表面镀层	Contactive Coating		镀锡 Tin Plated					
一般参数 Other Data								
间距	Pitch [mm]		2.5					
极数	Poles [P]		2-12					
剥线长度	Stripping Length [mm]		6					
螺丝	Screw/扭矩 Torque(Max) [N.m]		-					
工作温度	Operating temperatur [°C]		-60~+105					
引针尺寸	Pin Dimensions [mm]		2.1					
PCB板孔径	PCB Hole Diameter [mm]		1.2					

DES.	SJD	DATE	21.11.15
CHK.	BY	DATE	21.11.15
APP.	CLF	DATE	21.11.15

单位/UNITS mm 尺寸/SIZE A4 比例/SCALE 1:1

慈溪市科发电子有限公司
CIXI KEFA ELECTRONIC CO., LTD

第三视角/THIRD ANGLE PROJECTION

版本/REV A

名称/TITLE **KF2025AR-2.5**